

INSIDE FIT CUTTING SHOES

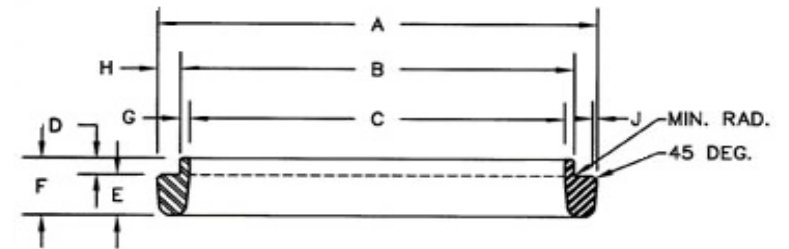
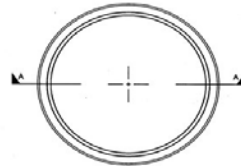
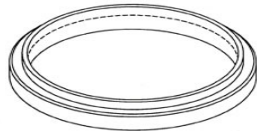

Specification: ASTM A27/ASTM A148

Other size and grade can be produced; subject to agreement.

Code	Specification and Grade	Fit Pipe			A		B		C		D		E		F	
		O.D. (inch)	O.D. (mm)	Max. Wall (mm)	Inch	mm	Inch	mm	Inch	mm	Inch	mm	Inch	mm	Inch	mm
CND6.62SICS	ASTM A27 GR.70-40	6.625	168.3	12.7	6.625	168.3	5.625	142.9	4.625	117.5	0.75	19.1	1.75	44.5	2.5	63.5
CND8.625ICS	ASTM A27 GR.70-40	8.625	219.1	12.7	8.625	219.1	7.625	193.7	6.625	168.3	0.75	19.1	2	50.8	2.75	69.9
CND10.75ICS	ASTM A27 GR.70-40	10.75	273.1	12.7	10.875	276.2	9.75	247.7	8.625	219.1	0.75	19.1	2	50.8	2.75	69.9
CND12.75ICS	ASTM A27 GR. 70-40	12.75	323.9	14.3	12.875	327.0	11.625	295.3	10.625	269.9	0.75	19.1	2	50.8	2.75	69.9
CND14ICS	ASTM A27 GR. 70-40	14	355.6	12.7	14.125	358.8	13	330.2	11.875	301.6	0.75	19.1	2	50.8	2.75	69.9
CND16ICS	ASTM A27 GR.70-40	16	406.4	14.3	16.125	409.6	14.875	377.8	13.875	352.4	0.75	19.1	2	50.8	2.75	69.9
CND16ICS	ASTM A27 GR. 70-40	16.375	415.925	17.5	16.5	419.1	15	381.0	14	355.6	0.75	19.1	2	50.8	2.75	69.9
CND18ICS	ASTM A27 GR.70-40	18	457.2	12.7	18.125	460.4	17	431.8	15.875	403.2	0.75	19.1	2	50.8	2.75	69.9
CND20ICS	ASTM A27 GR. 70-40	20	508	15.9	20.125	511.2	18.75	476.3	17.75	450.9	0.75	19.1	2.5	63.5	3.25	82.6
CND20ICS-S	ASTM A27 GR. 70-40	20-S"	508	19.1	20.125	511.2	18.5	469.9	17.75	450.9	0.75	19.1	2.5	63.5	3.25	82.6
CND24ICS	ASTM A27 GR. 70-40	24	609.6	19.1	24.25	616.0	22.5	571.5	21.5	546.1	0.75	19.1	2.5	63.5	3.25	82.6
CND26ICS	ASTM A27 GR. 70-40	26	660.4	18.3	26.25	666.8	24.562	623.9	23.625	600.1	0.75	19.1	2.5	63.5	3.25	82.6
CND30ICS	ASTM A27 GR. 70-40	30	762	19.1	30.25	768.4	28.5	723.9	27.75	704.9	0.75	19.1	2.5	63.5	3.25	82.6
CND30ICS-S	ASTM A27 GR.70-40	30	762	25.4	30.25	768.4	28	711.2	27.25	692.2	0.75	19.1	2.5	63.5	3.25	82.6
CND36ICS	ASTM A27 GR. 70-40	36	914.4	20.6	36.25	920.8	34.375	873.1	33.5	850.9	0.75	19.1	2.5	63.5	3.25	82.6
CND36ICS-XS	ASTM A27 GR. 70-40	36	914.4	25.4	36.25	920.8	34	863.6	33	838.2	0.75	19.1	2.5	63.5	3.25	82.6
CND36ICS-XXS	ASTM A27 GR.70-40	36	914.4	40.0	36.25	920.8	32.85	834.4	32.1	815.3	0.75	19.1	2.5	63.5	3.25	82.6
CND42ICS	ASTM A27 GR.70-40	42	1066.8	25.4	42.25	1073.2	40	1016.0	39	990.6	0.75	19.1	2.5	63.5	3.25	82.6
CND48ICS	ASTM A27 GR.70-40	48	1219.2	27.0	48.25	1225.6	45.875	1165.2	44.875	1139.8	0.75	19.1	3	76.2	3.75	95.3